

SEZIONE AA'

scala 1:50

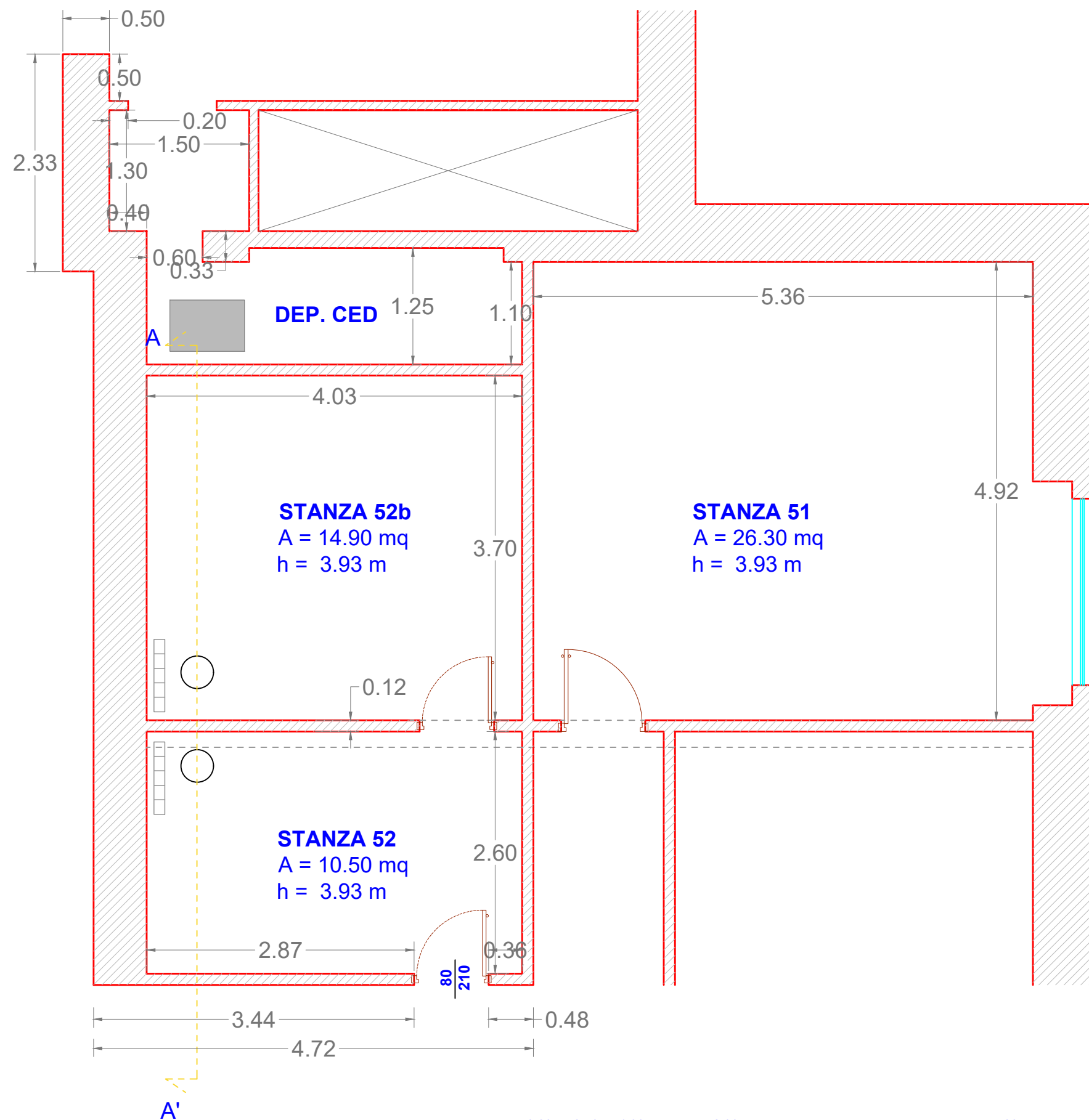

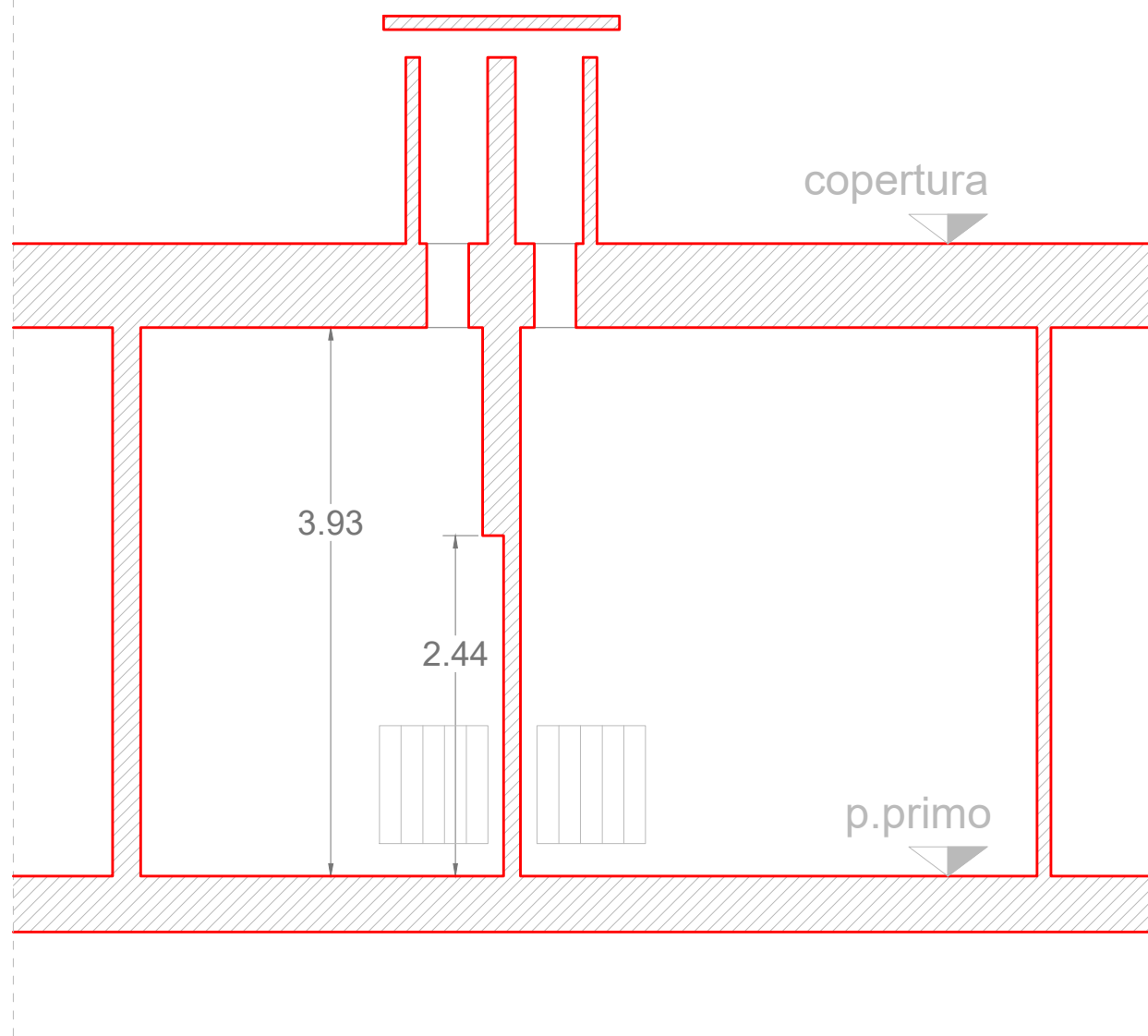



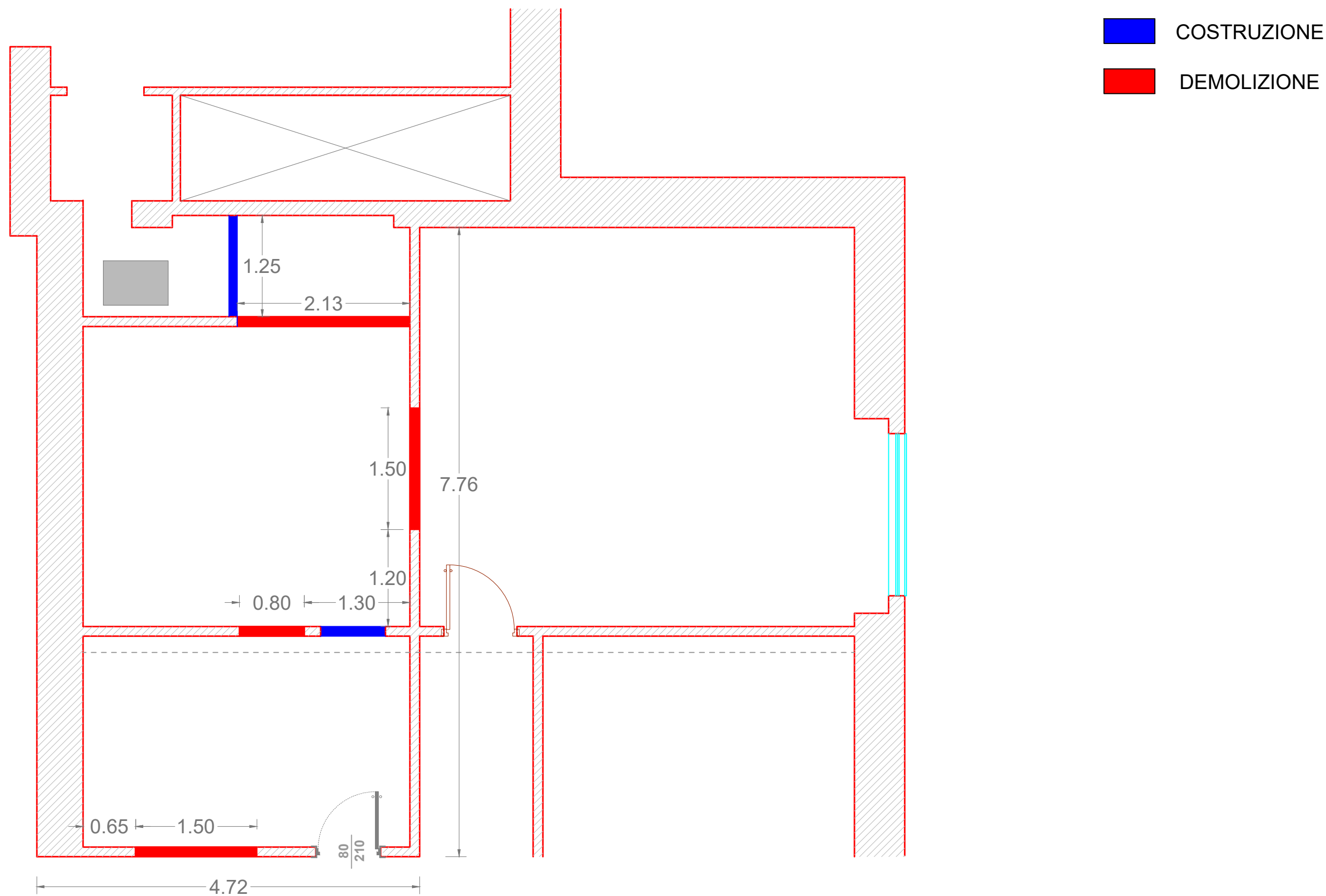

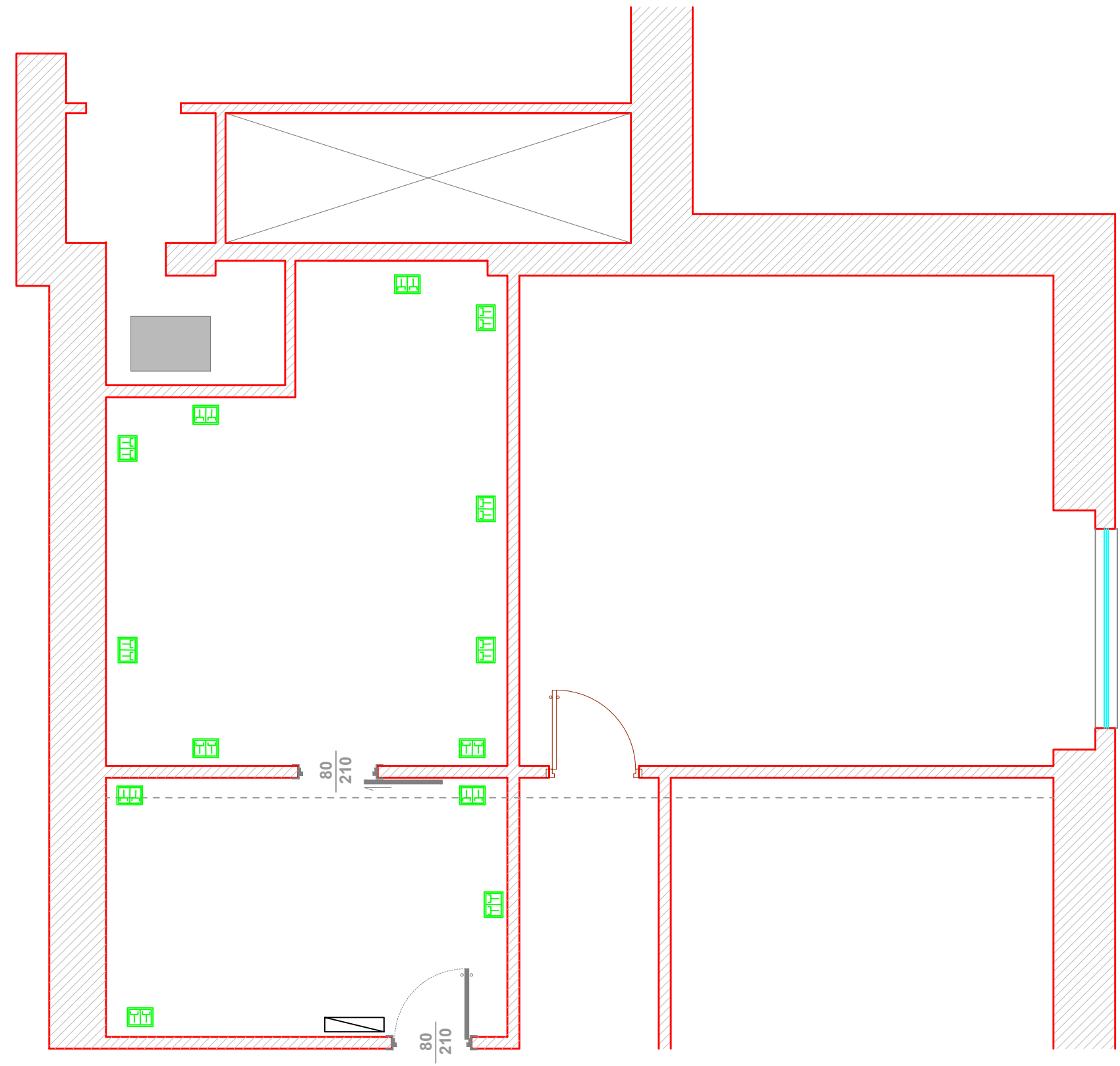



PROGETTO POST OPERAM - DEMOLIZIONI E RICOSTRUZIONI

scala 1:50





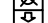

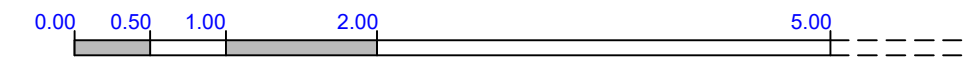

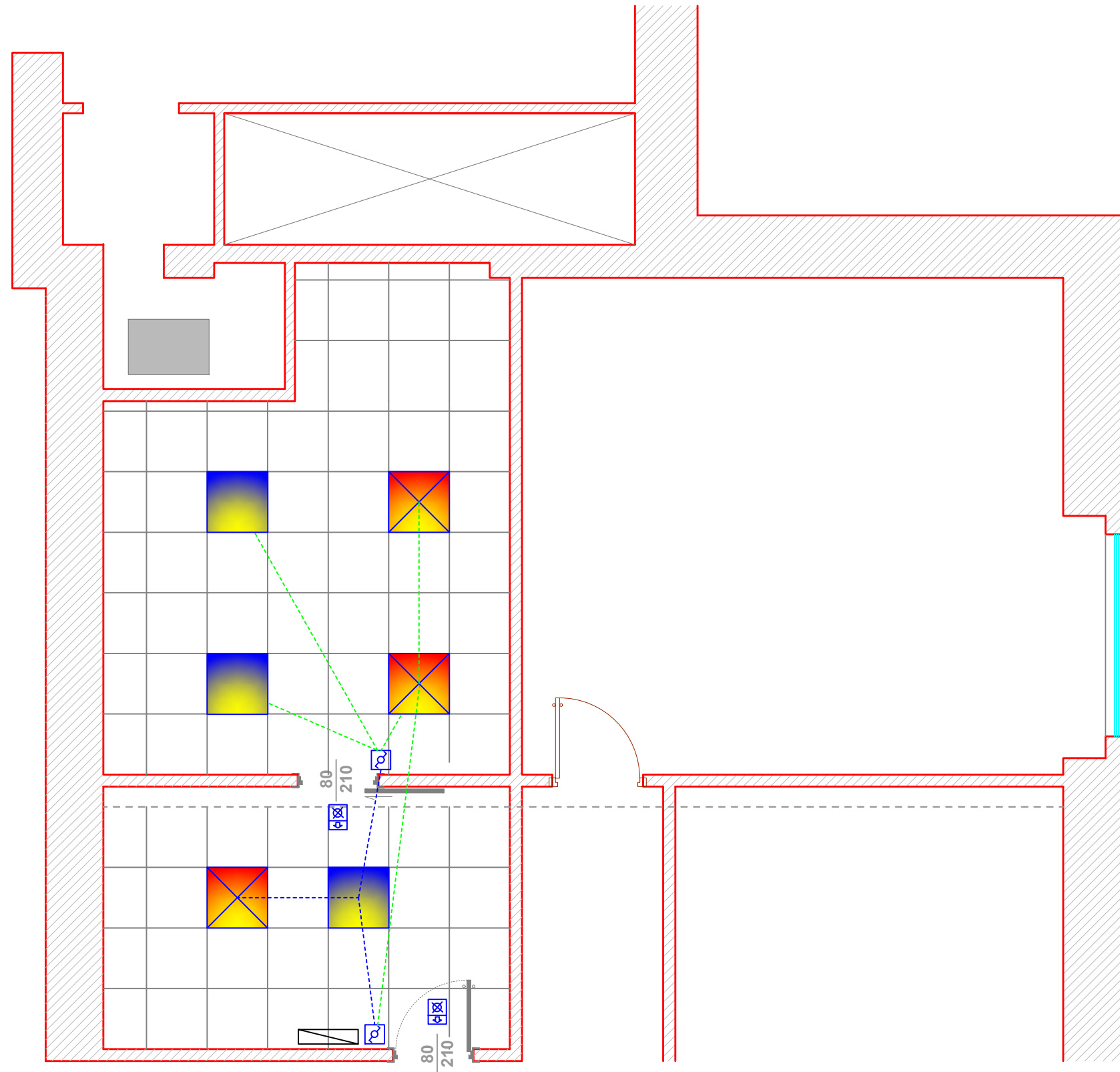





-  QUADRO ELETTRICO
-  TORRETTA
-  INTERBLOCCATA CEE 16A/32A
-  INTERBLOCCATA CEE
-  PRESA UNEL 2P+T IN CONTENITORE DA ESTERNO
-  PRESA BIPASSO 2P+T IN CONTENITORE DA EST.
-  DEVIATORE UNIPOLARE IN CONTENITORE DA EST.
-  INTERRUTTORE UNIPOLARE IN CONTENITORE DA EST.
-  PRESA RJ45
-  PANNELLO DIMMERABILE 60x60cm
-  PANNELLO di EMERGENZA "SA" 60x60cm









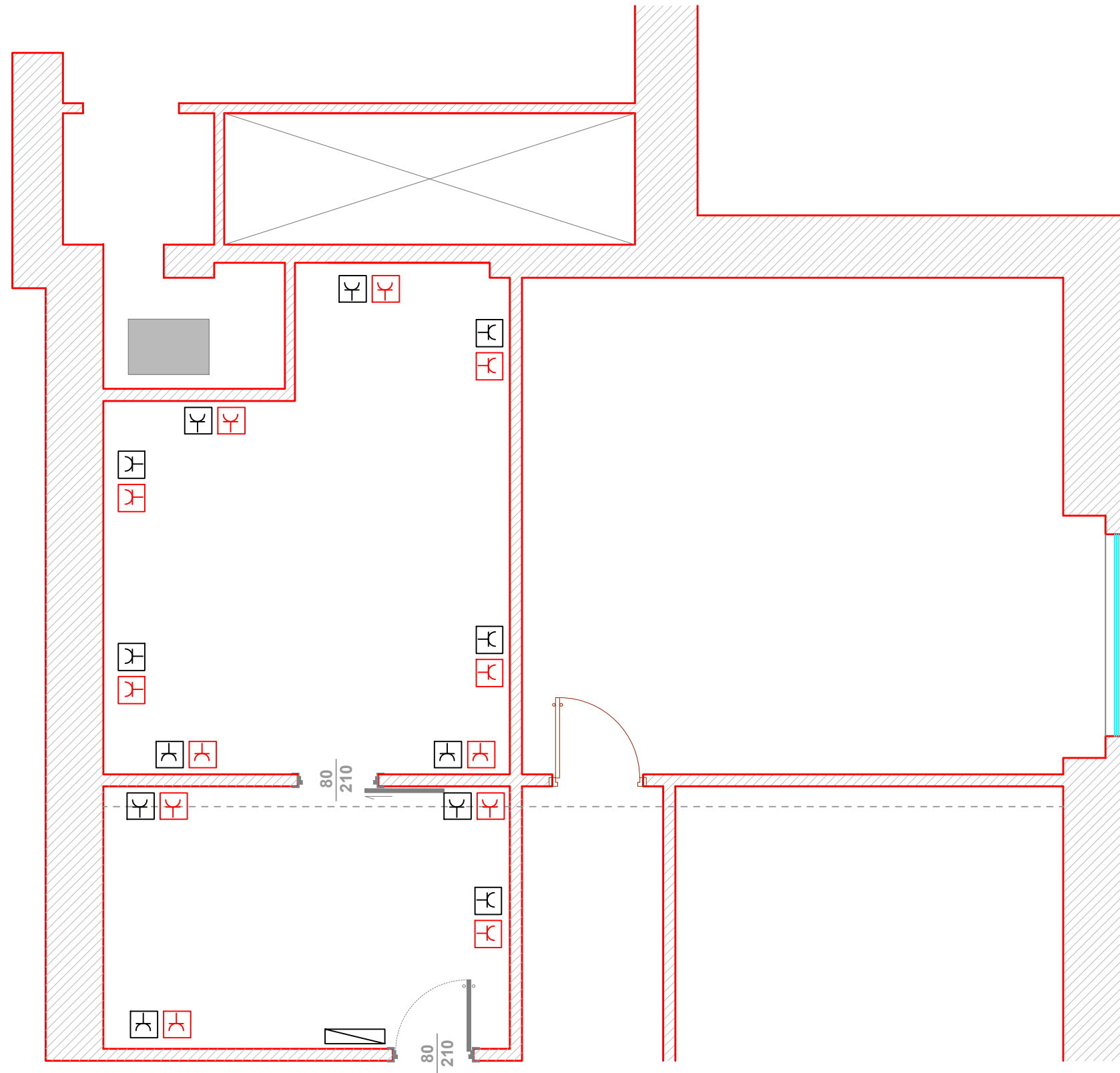



-  QUADRO ELETTRICO
-  TORRETTA
-  INTERBLOCCATA CEE 16A/32A
-  INTERBLOCCATA CEE
-  PRESA UNEL 2P+T IN CONTENITORE DA ESTERNO
-  PRESA BIPASSO 2P+T IN CONTENITORE DA EST.
-  DEVIATORE UNIPOLARE IN CONTENITORE DA EST.
-  INTERRUTTORE UNIPOLARE IN CONTENITORE DA EST.
-  PRESA RJ45
-  PANNELLO DIMMERABILE 60x60cm
-  PANNELLO di EMERGENZA "SA" 60x60cm



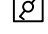
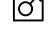

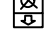
-  QUADRO ELETTRICO
-  TORRETTA
-  INTERBLOCCATA CEE 16A/32A
-  INTERBLOCCATA CEE
-  PRESA UNEL 2P+T IN CONTENITORE DA ESTERNO
-  PRESA BIPASSO 2P+T IN CONTENITORE DA EST.
-  DEVIATORE UNIPOLARE IN CONTENITORE DA EST.
-  INTERRUOTORE UNIPOLARE IN CONTENITORE DA EST.
-  PRESA RJ45
-  PANNELLO DIMMERABILE 60x60cm
-  PANNELLO di EMERGENZA "SA" 60x60cm



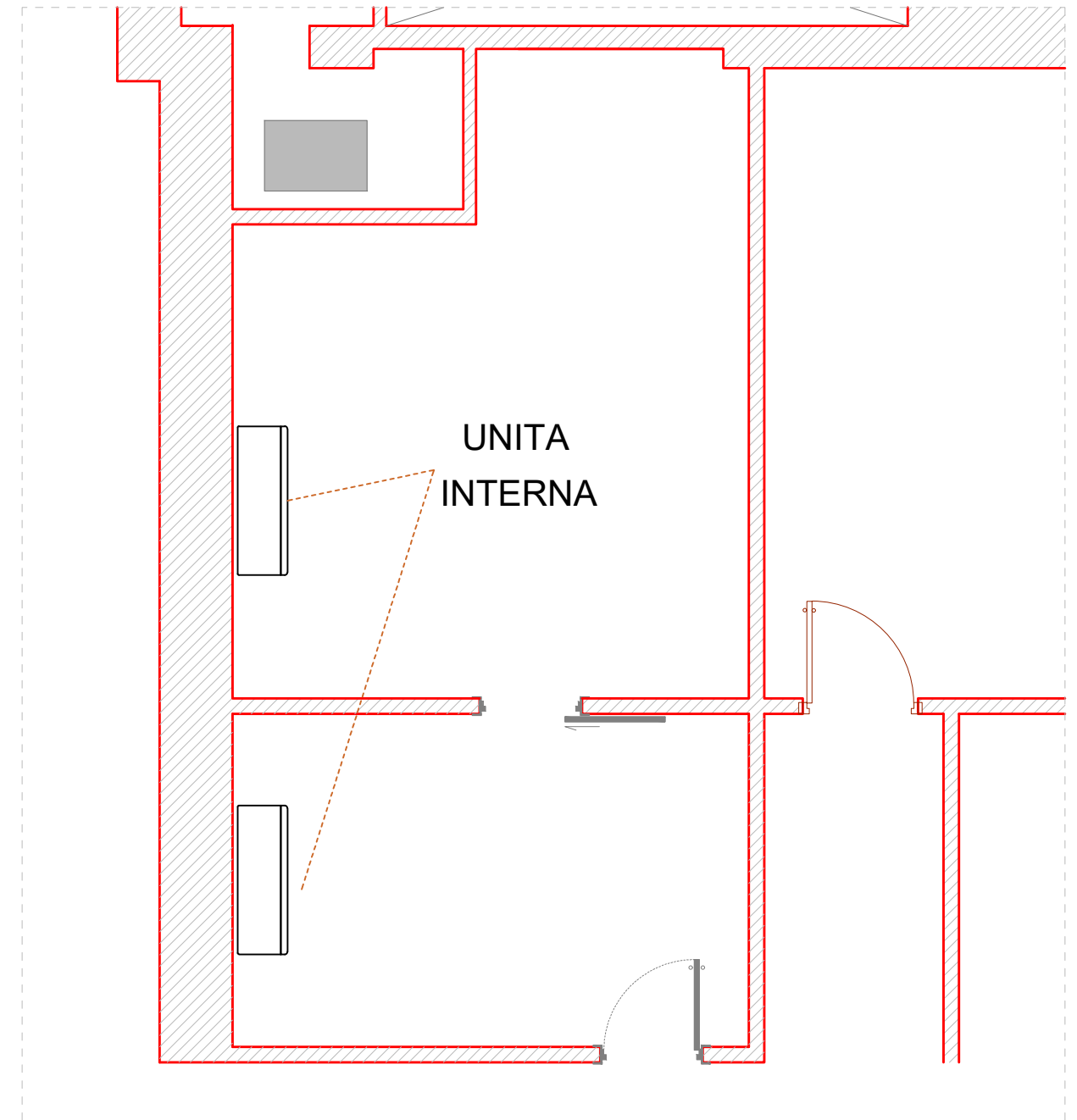
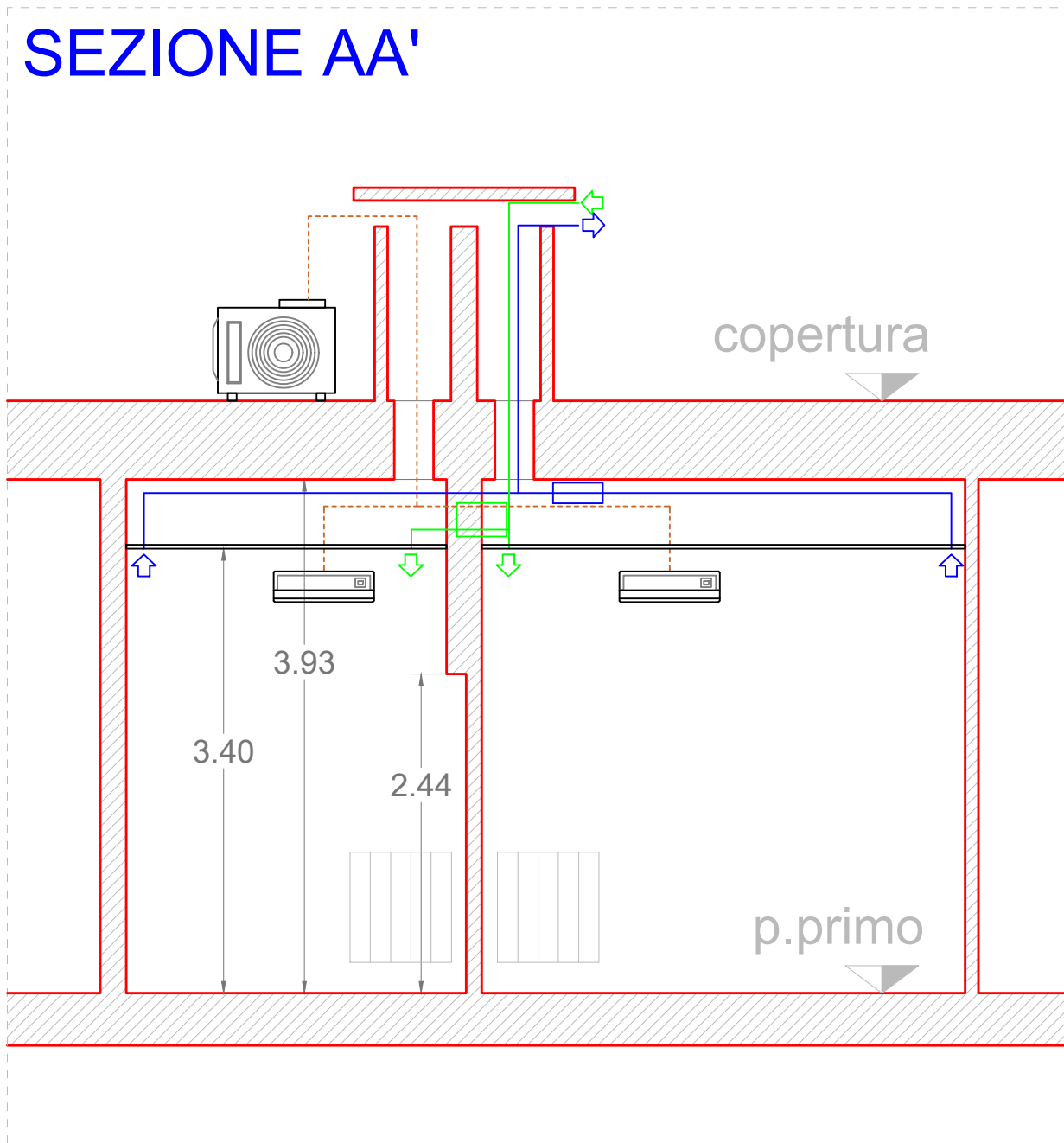

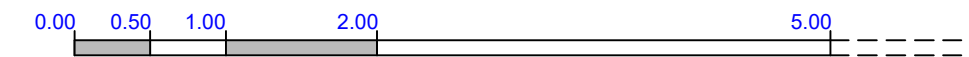
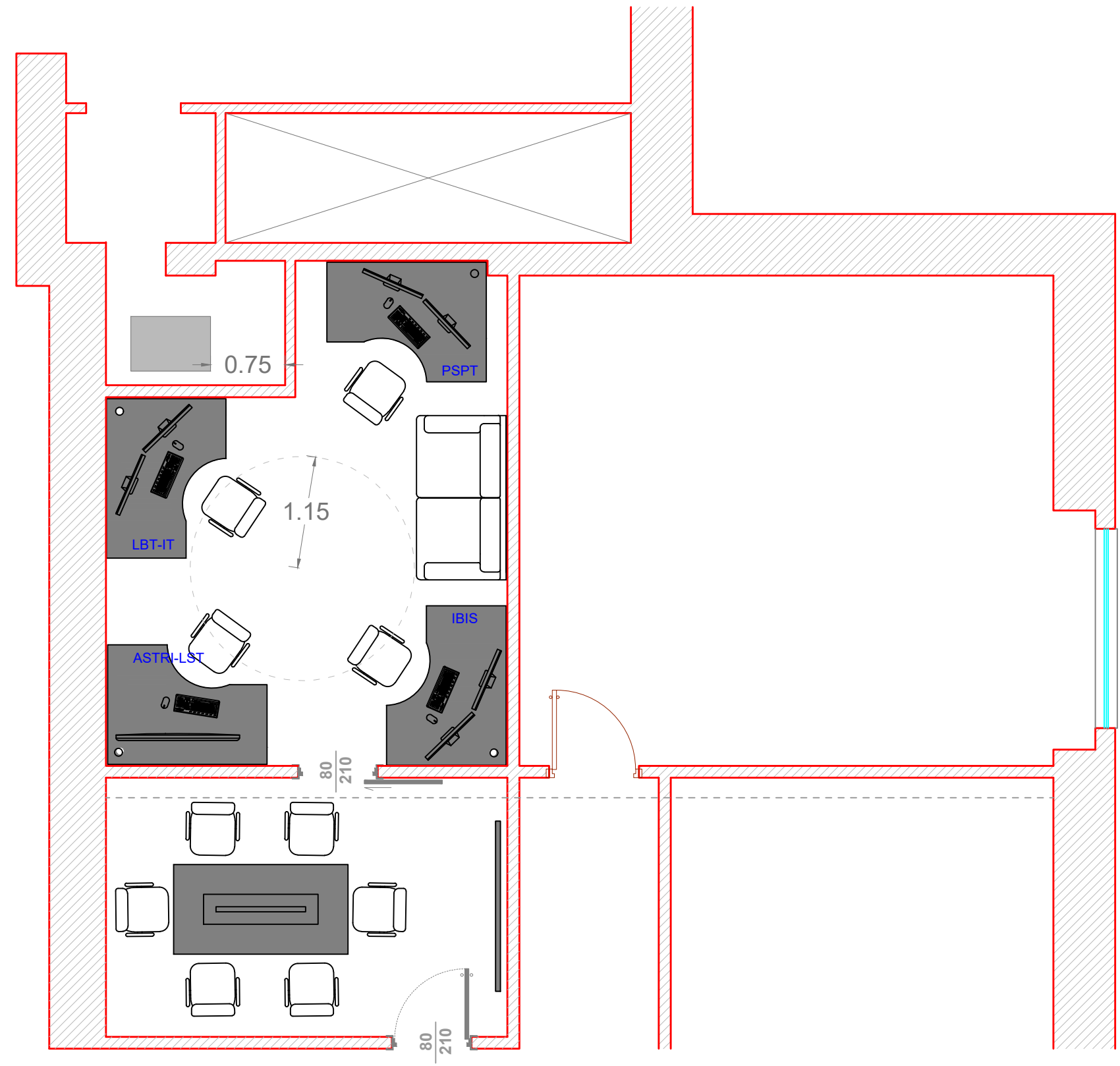

PIANO PRIMO

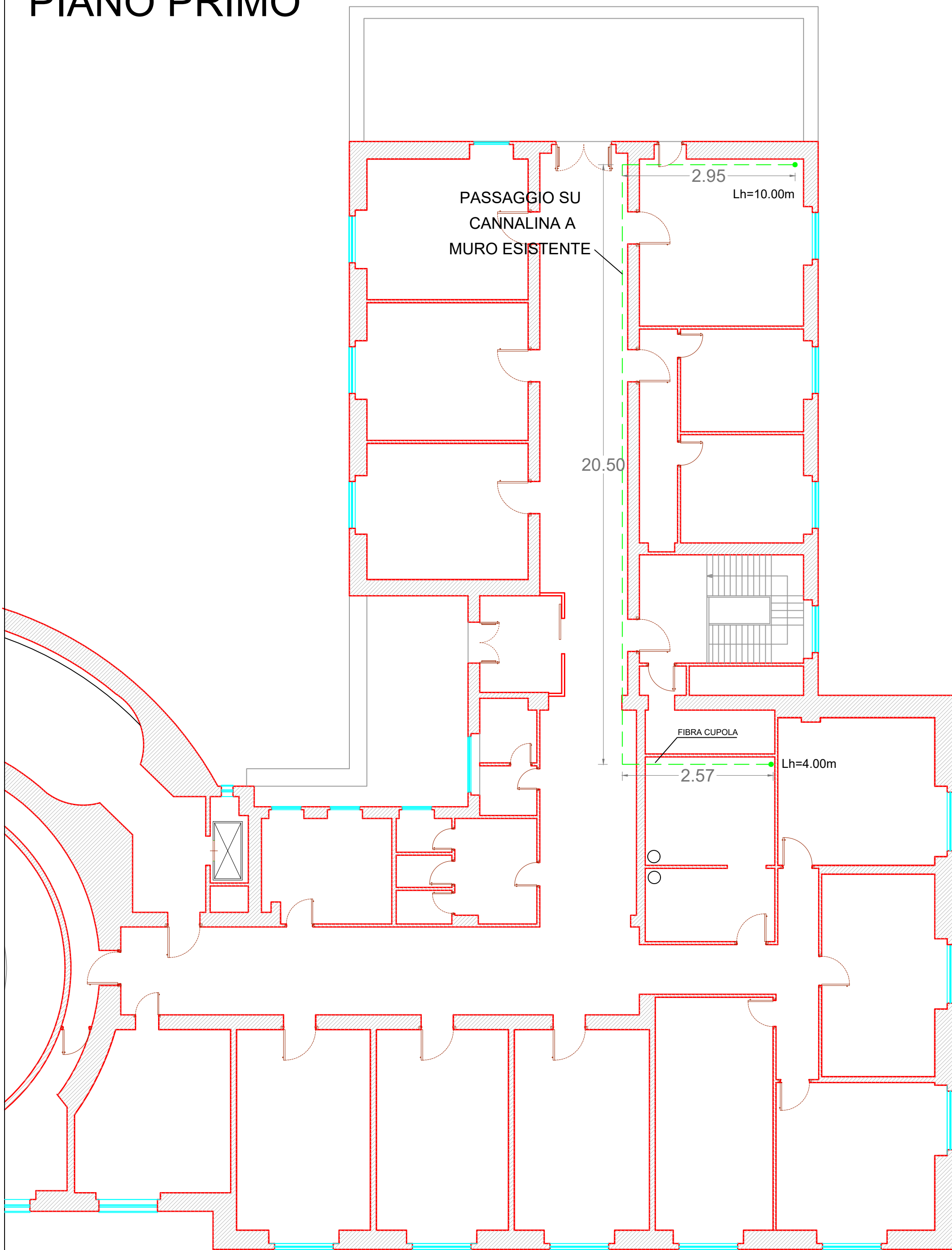

20.50

2.95

Lh=10.00m

PASSAGGIO SU
CANNALINA A
MURO ESISTENTE

FIBRA CUPOLA

2.57

Lh=4.00m

0.00 0.50 1.00 2.00 5.00

PIANO COPERTURA

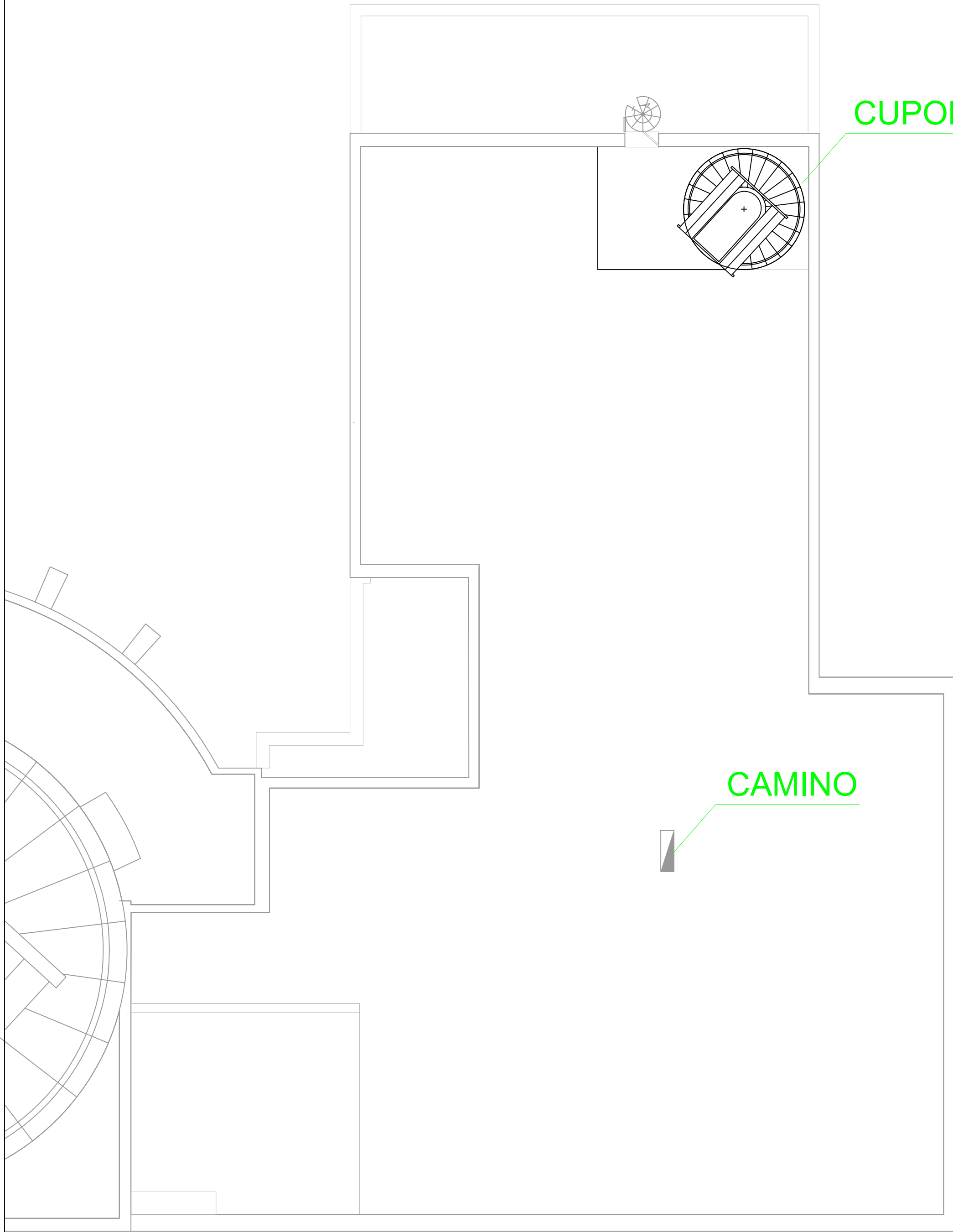

CUPOLA

CAMINO

